



**REGISTER  
YOUR WARRANTY  
ONLINE AT  
[www.sanuvox.com](http://www.sanuvox.com)**

## P900-GX PORTABLE UV AIR PURIFIER Residential Model



### IMPORTANT SAFETY INSTRUCTIONS

**READ AND SAVE THESE SAFETY INSTRUCTIONS BEFORE USING THIS PRODUCT.**



**Read and follow all instructions contained in this manual before using the product. Failure to comply with these instructions may result in personal injuries or damage to the unit or system.**

1. **Installation and servicing** of air conditioning and related equipment **can be hazardous** due to systems pressure and electrical components. **Only trained and qualified service personnel** should install, repair or service equipment.
2. **Untrained personnel** can perform **basic maintenance** functions such as replacing lamp(s) and/or filter(s). All other operations should be performed by trained service personnel.
3. When working on the unit or system, observe precautions in the literature, tags and labels attached to the unit or system, and all other safety precautions considered as best practices in the HVAC industry.
4. When applicable, local regulation may comprise more restrictive installation and/or certification requirements. The afore mentioned requirements prevail on those of this document and the installer agrees to conform to these at his own expense.
5. Follow all the safety instructions outlined in this document and respect all local and national codes applicable.
6. **Never expose eyes or skin to ultraviolet light from any source.** Therefore, **before installing or performing maintenance** on the unit or system, **TURN OFF AND DISCONNECT** the unit or system **from all power sources** (there may be more than one switch to disconnect).  
⚠ **CAUTION:** Electrical shock may cause personal injuries or possibly death.
7. UV rays may destroy certain types of filters (polymer or plastic); please keep the unit or system light away from shining directly on plastic.
8. When installing or performing maintenance on the UV unit or system, it is recommended to **wear safety glasses and gloves**. In order to avoid reduced performance of lamp(s), **do not touch lamp glass without gloves**.
9. UV lamps contain a small quantity of mercury: if a lamp breaks, clean and **dispose of with care**. UV lamps can be disposed/recycled after use, as any other fluorescent lamps. Contact and follow your local and national authorities' specific instructions.
10. **Use only specified SANUVOX branded replacement UV lamps with your unit or system.** Use of any other lamps will void your warranty and can result in damage to the unit, system and/or lamp(s).
11. Most UV units or systems are not waterproof. **DO NOT INSTALL OUTDOORS** unless specified otherwise.

**SAVE THESE INSTRUCTIONS**

**Installation Date:** \_\_\_\_\_ **Installed by:** \_\_\_\_\_

**Installer Contact Info.:** \_\_\_\_\_

## **TABLE OF CONTENTS**

△ IMPORTANT SAFETY INSTRUCTIONS △	1
TABLE OF CONTENTS	2
ABOUT THE PRODUCT	3
COMPONENTS	3
How it Works	3
SETUP & INSTALLATION	4
What you will need	4
What's included	4
Step by Step Setup & Installation	4
Step by Step Stand Installation	5
Step by Step Handle Installation	5
OPERATION	6
How to Operate your Product	6
How to Read the Control Panel Display	6
Default Settings	6
How to Switch from Default to Timer Mode	6
Step by Step Adjust Fan Speed	7
MAINTENANCE	7
How to Replace Lamp(s)	7
Step by Step Lamp Replacement	7
How to Clean your Product	9
Step by Step Inlet Filter Cleaning	9
STORAGE	10
ULTRAVIOLETS: UVV & UVC	10
ELECTRICAL RATINGS, POWER CONSUMPTION & AVAILABLE VOLTAGE	10
TROUBLESHOOTING	10
What you will need	10
Problems & Solutions Table	10
A. Step by Step Verification of Motor Wire Connection	11
WARRANTY	12
CUSTOMER SERVICE	12

## ABOUT THE PRODUCT

Congratulations on the purchase of your new Sanuvox ultraviolet air purifier. Sanuvox UV air purifiers are the most advanced air purification systems available, having been proven to destroy up to 99.999% of biological and chemical contaminants that circulate throughout your home or facility. Sanuvox systems have been tested by the EPA (Environmental Protection Agency), the National Homeland Security Research Center, medical universities and independent third party laboratories.

The P900-GX is designed to purify up to 900 square feet, destroying chemical and biological contaminants. The unit is designed for small homes and apartments, and can be used in commercial areas.

For information or recommendations on how to size your specific application, please call SANUVOX at 1-888-726-8869.

## COMPONENTS

### How it Works

Contaminated air enters the P900-GX parallel to the UV 'J' lamp, thus increasing contact time with the UV energy. First, the air goes through an inlet filter that captures particles. After, the UVV oxidizing section of the lamp destroys chemicals and odors, the UVC germicidal section of the lamp destroys biological contaminants. Finally, the purified air circulates through the home.

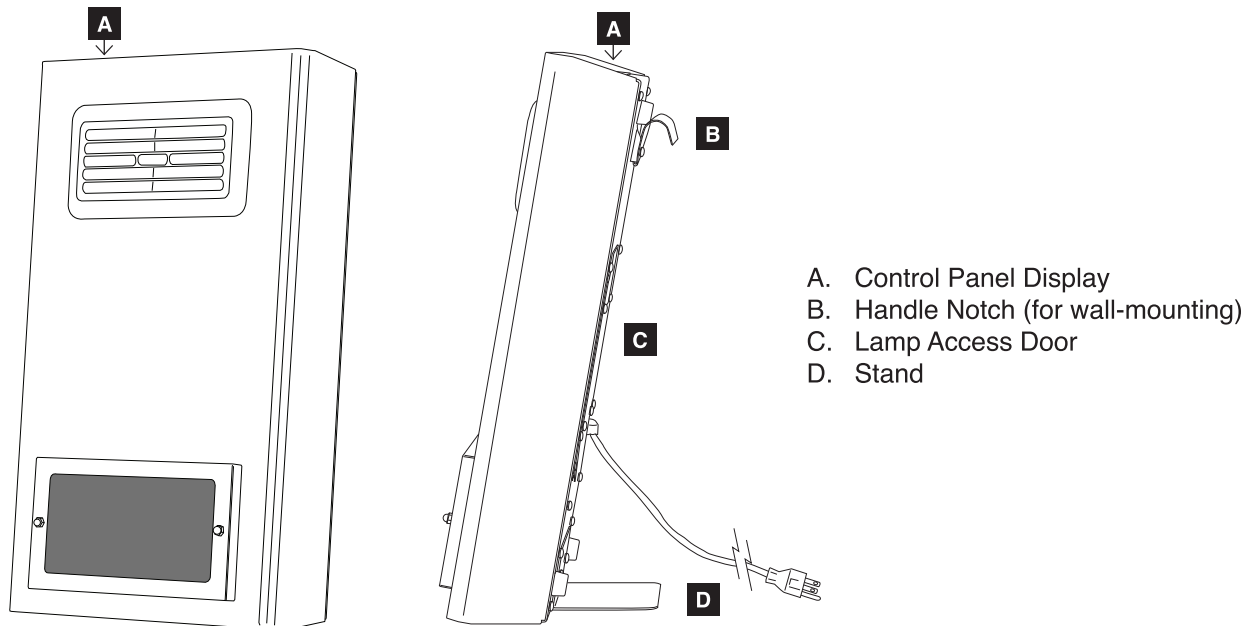

## SETUP & INSTALLATION

### What you will need

A utility knife to unpack all components and a Phillips No.2 screwdriver.

⚠ **CAUTION:** Handle your product with care to avoid breaking parts. Make sure you have a free and safe space to unpack, install and setup your product. Confirm you have access to the necessary power source for the product requirements (see unit or system label). If you have any questions regarding the installation instructions, call SANUVOX at 1-888-726-8869.

### What's included

The P900-GX with its UV lamp and a basic installation kit.

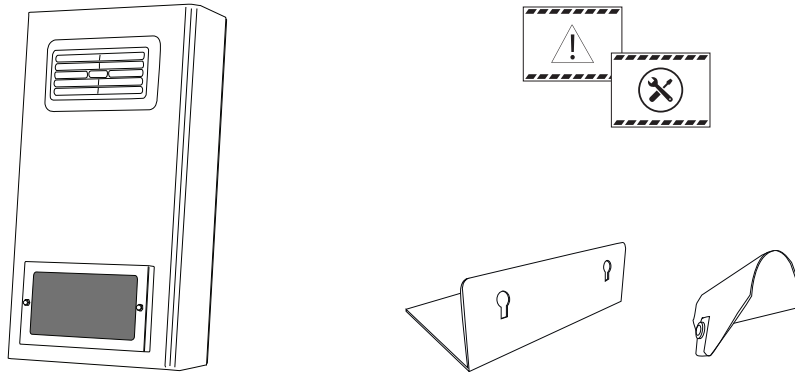

The installation kit includes: a UV caution decal, a maintenance decal, a stand and an handle with its screw (1).

## Step by Step Setup & Installation

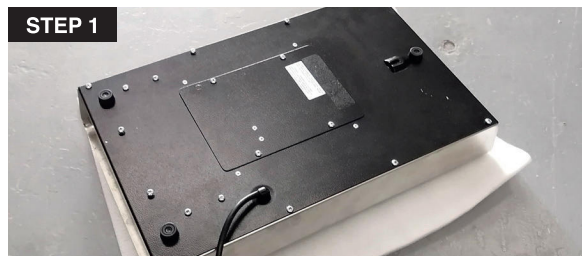

1. **Prepare the P900-GX for installation.** Remove unit from packaging. Before plugging the P900-GX, turn it face down and place on soft surface to protect top.

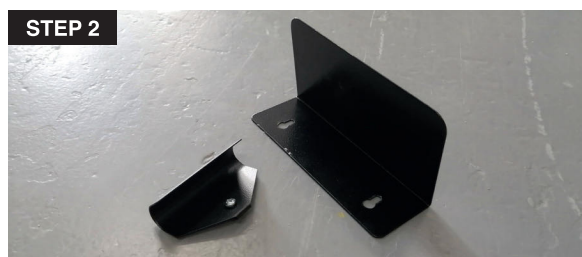

2. Install stand or handle.  
**See Stand and Handle Installation instructions on page 5.**



3. Replace the P900-GX upright or on wall and plug the purifier in a wall outlet.

**You are now ready to power ON your new P900-GX and enjoy great air quality for you and your family.**

## Step by Step Stand Installation

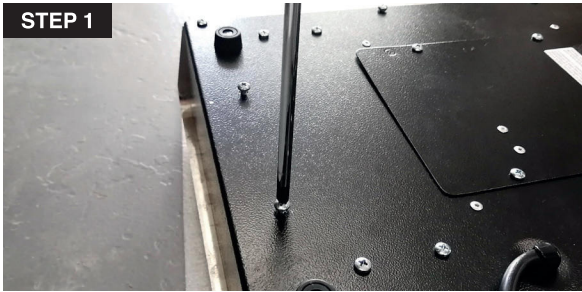

1. Loosen the two bottom screws between the two rubber feet.

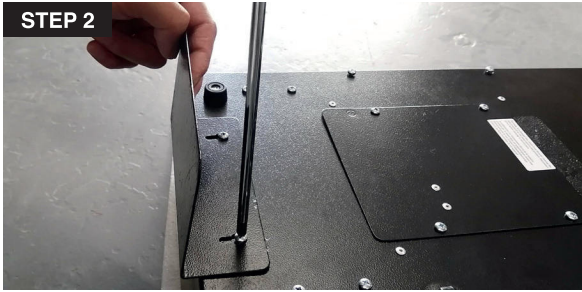

2. Slide the stand through the two screws and tighten.

## Step by Step Handle Installation

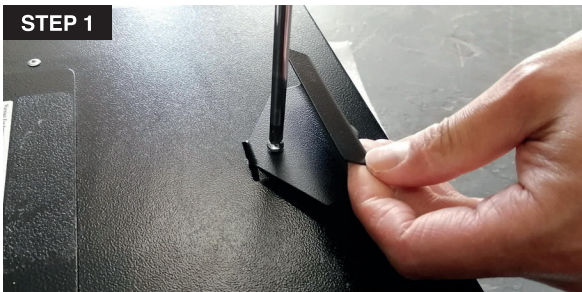

1. The handle fits into the wall/ handle notch just under the middle rubber foot. Slide the handle in and tighten the screw.